

LogiLink®

Alumium Dual Monitor Desk Mount with Gas Spring for 13"-32" Flat & Curved Monitor

Art. No.: BP0043

Easy installation and compatible with VESA standard max. 100x100mm.

Features:

- » Super strong mounting brackets: Solid-reinforced Cold Steel, durable product with maximum capacity of 9kg for each arm
- » Maximum arm extension length is 525mm, Tilt capacity: 90°~-90°, Swivel capacity: 90°~-90° and Rotation capacity: 90°~-90°
- » Compatible with VESA 75x75mm, 100x100mm
- » Clamp and grommet mount included
- » Easy to install
- » Fit for 13-32 inch LCD Monitor

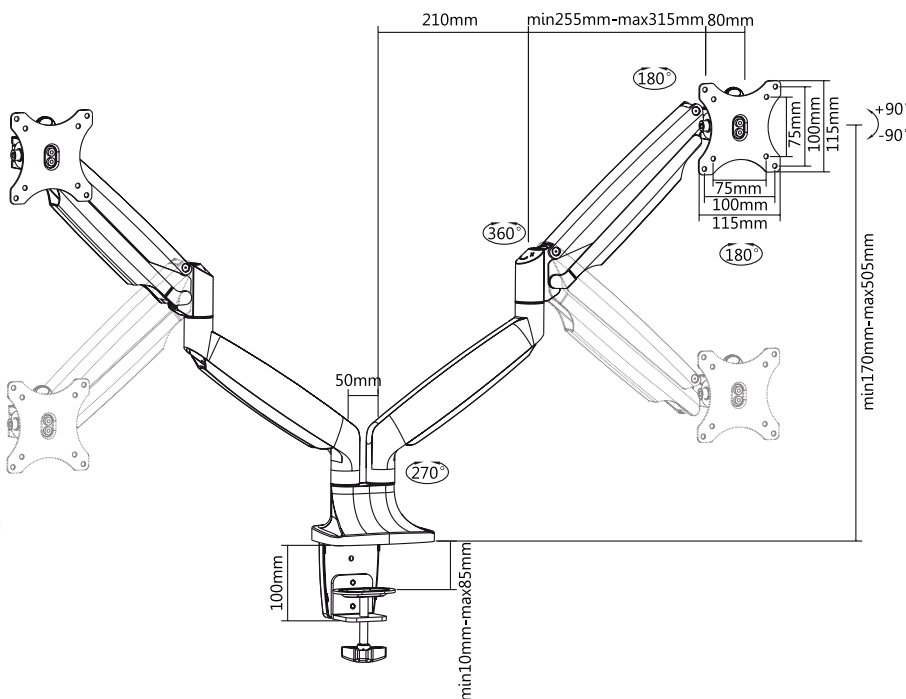

* The specifications and pictures are subject to change without notice.
* All trade names referenced are the registered namework of their respective owners.



BP0043



4 052792 046489

Made in China

LogiLink®

Alumium Dual Monitor Desk Mount with Gas Spring for 13"-32" Flat & Curved Monitor

Art. No.: BP0043



1

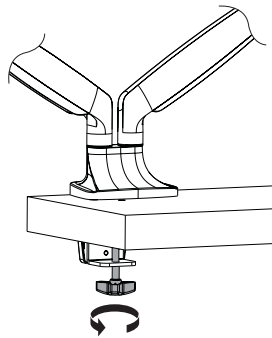

2

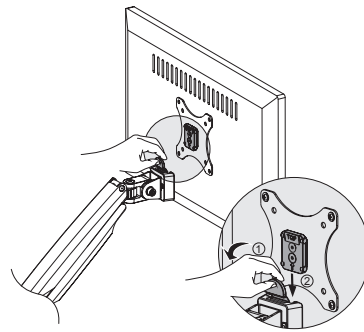

3

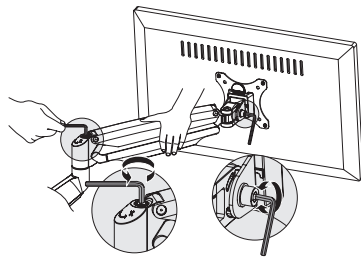

4

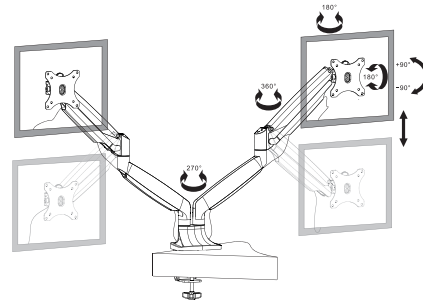

Specification:

| | |
|--------------|--------------------------------|
| Screen Size | 13"-32" |
| Rated Load | 1-9kg/2.2-19.8lbs for each arm |
| VESA | 75x75, 100x100 |
| Arm Extend | 525mm |
| Tilt | 90° ~ -90° |
| Swivel | 90° ~ -90° |
| Rotate | 90° ~ -90° |
| Product Size | 1100 x 125 x 670mm |

Fits
13"-32"
Monitor

VESA
Max.
100x100mm

**Arm
Extend**
525mm

Each
Arm
rated
1-9kg/
2.2-19.8lbs

**Gas
Spring
Arm**

ROTATION
-90° 90°

TILT
90° -90°

SWIVEL
90° -90°

**Direction
Indicator**

**Curved
Monitor**

Package Contents:

- » 1 x Alumium Dual Monitor Desk Mount
- » 1 x Screw Package
- » 1 x User Manual

Package Informations:

- » Packing Dimension: mm
- » Packing Weight: kg
- » Carton Dimension: mm
- » Carton Q'ty: pcs
- » Carton Weight: kg

RoHS
compliant

* The specifications and pictures are subject to change without notice.
* All trade names referenced are the registered namework of their respective owners.

